



# Closed Syringe Adaptor

**REF** CSA100

## Instructions for Use

### Description

The Halo<sup>®</sup> Closed Syringe Adaptor is intended for use in the closed reconstitution and transfer of antineoplastic and hazardous drugs from vial to patient in a healthcare setting. Compatible with Luer Lock connections. Sterile (ethylene oxide). Sterile unless package is damaged. Use required and accepted IV practice. Do not reuse to avoid contamination. Rx Only.

### Indication for Use

The Halo<sup>®</sup> system is an airtight and leak proof closed system drug transfer device (CSTD) that mechanically prohibits the transfer of environmental contaminants into the system and the escape of drug or vapor concentrations outside the system, thereby minimizing individual and environmental exposure to drug vapor, aerosols and spills. The Halo<sup>®</sup> system also prevents microbial ingress for up to 7 days.

### Precaution

When attaching Closed Syringe Adaptor to drug vial assemblies with thick concave rubber stoppers, make sure the Closed Syringe Adaptor is fully compressed and pressure equalization is working. Do not use if protective caps are loose or displaced. Always grip white components when using the Corvida Medical Halo<sup>®</sup> System. Do not use Corvida Medical Halo<sup>®</sup> Closed Line Adaptor as a protection cap together with Closed Syringe Adaptor. When Closed Syringe Adaptor is connected to the distal end of an infusion line for long term infusion, total activation time of Closed Syringe Adaptor in Closed Line Adaptor should not exceed 24 hours. Clamp the lines before disengaging the Closed Syringe Adaptor from the Closed Line Adaptor.

The sealing membranes are validated for up to 14 perforations. The performance of the sealing membrane may be reduced after multiple perforations. Discard after 14 perforations. Disinfect the CSA and mating component seals by swabbing with 70% isopropyl alcohol (IPA) or other validated method before each reconnection.

### Warning

Subject device is not intended as being capable of modifying or superseding drug labeling recommendations for storage of medications contained within the subject device.

### Symbol Legend

REF	Catalogue number	!	Caution, consult accompanying documents
LOT	Batch code	STERILEEO	Sterilized using ethylene oxide
	Do not re-use		Use by date
	Do not use if package is damaged		Caution: Federal law (US) restricts this device to sale by or on the order of a physician
	Temperature limits to which the device can be safely exposed		Manufacturer Corvida Medical, Inc.

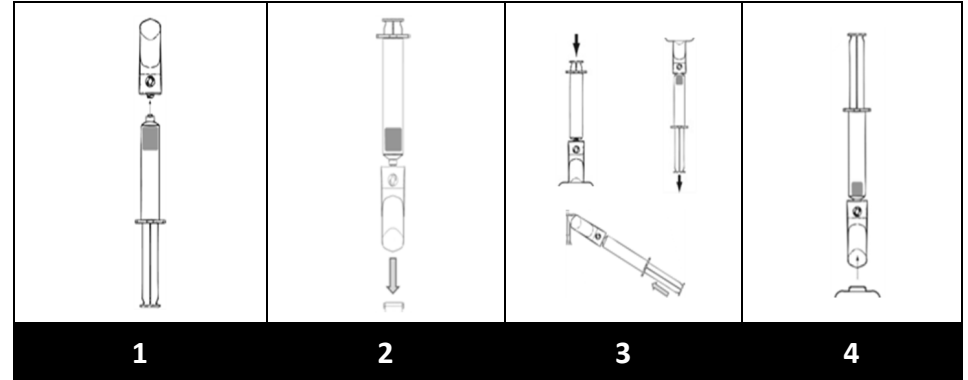
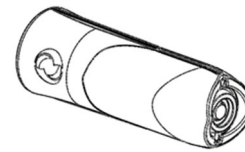

### Instructions for Use

1. Draw a volume of air equivalent to the dose or required volume of diluent into the luer-locking syringe. Connect Closed Syringe Adaptor to the luer-locking tip of the syringe. As an alternate use, Closed Syringe Adaptor can be connected to the distal end of a luer-locking infusion line.
2. Push the Closed Syringe Adaptor onto the connection interface to engage.
3. Perform drug transfer.
4. Pull the Closed Syringe Adaptor to separate from the connection interface.
5. **Dispose** without disconnecting the Halo<sup>™</sup> components.

### Distributed By



Fresenius Kabi USA, LLC  
Three Corporate Drive  
Lake Zurich, Illinois 60047  
www.fresenius-kabi.us  
+1 800-933-6925